

99435

Dimensions

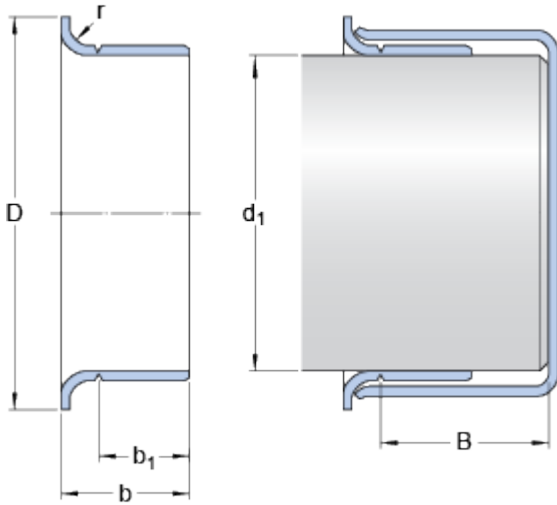

Nominal dimensions

d_1		110	mm
D		124.993	mm
Tolerance outside diameter D	\pm	1.6	mm
b		16.51	mm
Tolerance width b	\pm	0.8	mm
b_1		12.929	mm
Tolerance width b_1	\pm	0.8	mm
B	max.	31.75	mm
r	max.	3.18	mm

Shaft diameter range

d_1	min.	109.906	mm
d_1	max.	110.109	mm